

STAMFORD® S7

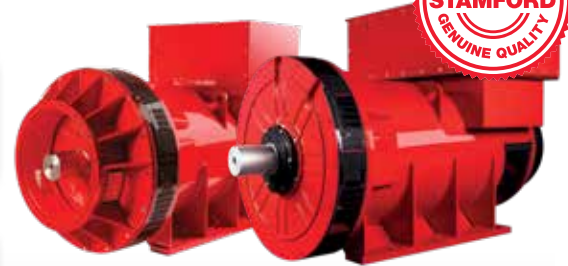

S7 LV

S7 HV

Model	S7 LV	S7 HV
Maximum continuous rating at 50Hz (kVA)	2,500	1625
Maximum continuous rating at 60Hz (kVA)	3,000	-

Specifications

Voltage Range	380-690	10,500 - 11,000
Poles	4	4
Technology	Wire Wound	Form Wound
AVR	Analogue	Digital
Voltage sensing	2 Phase	3 Phase
Bearing Arrangement	Single	Double
SAE Adaptors	SAE 0	None
Terminals	6	4
Temperature Monitoring	-	Winding RTDs 2/phase
Material Insulation Class	H	H
Excitation System	PMG	DECS100/PMG
Ingress Protection	IP23	IP23
Connection with other machines	Paralleling capability	Paralleling capability

Optional Features

Bearing Arrangement	Double	Single
SAE Adaptors	SAE 00	SAE0, SAE 00
Ingress Protection	IP44 Terminal Box	-
	IP44	-
Voltage Sensing	3 Phase sensing	-
AVR	DECS150	-
Temperature Monitoring	Winding RTDs	Bearing RTD
	Thermistors	
Terminals	-	6 terminals, open starpoint
Environmental Protection	Anti-Condensation Heater	Anti-Condensation Heater
Foot options	Flexible Foot	-

Designed For

Power Plant	●	●
Grid Code Compatible	●	●
Marine Propulsion	●	
Marine Auxiliary	●	
Oil & Gas		
Oil & Gas Auxiliary	●	
Combined Heat & Power	●	●
Critical Protection & UPS	●	●
Continuous Power & Standby	●	●

Prime Movers

Diesel Engine	●	●
Gas Engine	●	●

DIMENSIONS

Drawings represent standard design
All dimensions in millimetres (mm)

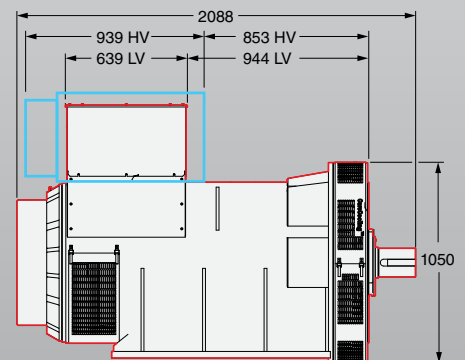
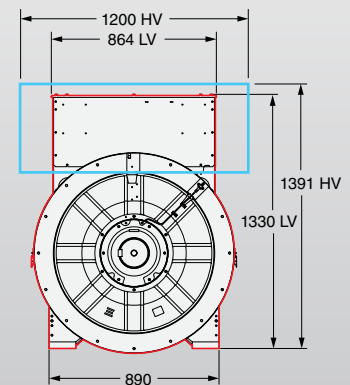

3 YEAR WARRANTY

Low Voltage

1,505 - 3,000 kVA

High Voltage

1080 - 1625kVA