

DIMENSIONS

Drawings represent standard design
All dimensions in millimetres (mm)

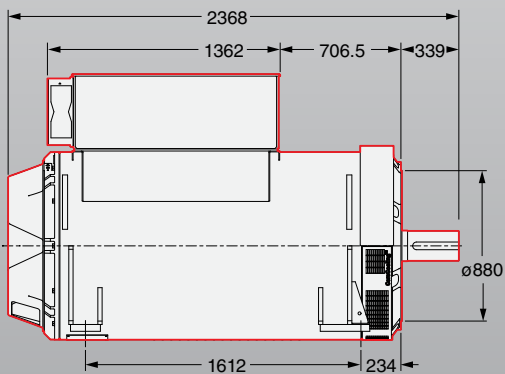
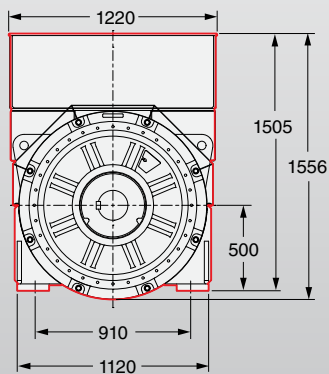

**3 YEAR
WARRANTY**

S9

STAMFORD®

Model	S9
Maximum continuous rating at 50Hz (kVA)	4,500
Maximum continuous rating at 60Hz (kVA)	5,000

Specifications	
Voltage Range	3,300 - 13,800
Poles	4
Technology	Bar Wound
AVR	Digital
Voltage sensing	2 Phase
Bearing Arrangement	Single/Double
SAE Adaptors	SAE 0 / 00
Centre height	500
Terminals	6
Material Insulation Class	H
Excitation System	PMG
Ingress Protection	IP23 IP54 Terminal Box
Connection with other machines	Paralleling capability
Temperature Monitoring	Winding RTDs

Optional Features	
Voltage Sensing	3 Phase
Centre height	265, 349, 450
Current transformers	1, 2, 3 per phase
Earth fault protection	Current Transformer

Designed For	
Power Plant	●
Grid Code Compatible	●
Marine Propulsion	
Marine Auxiliary	●
Oil & Gas	
Oil & Gas Auxiliary	●
Combined Heat & Power	●
Critical Protection & UPS	●
Continuous Power & Standby	●

Prime Movers	
Diesel Engine	●
Gas Engine	●

High Voltage
2,150 - 5,000 kVA